

GENERAL NOTES

DESIGN CRITERIA

- DESIGN IS BASED ON THE ASSUMPTION THAT THE MATERIAL WITHIN THE MECHANICALLY STABILIZED SOIL VOLUME, QUALITY OF PREFABRICATED MATERIAL AND METHODS OF CONSTRUCTION SHALL CONFORM TO THE CONTRACTING AGENCY'S TECHNICAL SPECIFICATIONS FOR MECHANICALLY STABILIZED STRENGTHENED SOIL WALLS.

2. ASSUMED SOIL CHARACTERISTICS:

SELECT BACKFILL

$\phi = 35$ DEGREES, $c = 0$ kPa, UNIT WEIGHT = 20.0 kN/Cu.m.

RANDOM BACKFILL

$\phi = 35$ DEGREES, $c = 0$ kPa, UNIT WEIGHT = 20.0 kN/Cu.m.

FOUNDATION MATERIAL

$\phi = 32$ DEGREES, $c = 0$ kPa, UNIT WEIGHT = 20.0 kN/Cu.m.

IF THE ACTUAL CHARACTERISTICS OF THE SOIL MATERIALS DIFFER FROM THOSE ABOVE, THEN SHAW TECHNOLOGIES, INC. SHOULD BE NOTIFIED PRIOR TO CONSTRUCTION TO EVALUATE ALTERNATIVE SOLUTION OF THE WALL(S).

- IT IS THE RESPONSIBILITY OF THE OWNER TO DETERMINE IF THE MAXIMUM APPLIED BEARING PRESSURE AT THE FOUNDATION LEVEL AS SHOWN IN THE DESIGN DOCUMENT IS ALLOWABLE FOR THE LOCATION.

- ANY UNSUITABLE FOUNDATION MATERIAL BELOW THE STRENGTHENED SOIL VOLUME, AS DETERMINED BY THE ENGINEER, SHALL BE EXCAVATED AND REPLACED WITH SUITABLE MATERIAL OR OTHERWISE STABILIZED AS DIRECTED BY THE ENGINEER.

- THE FRONT SIDE OF ALL STRENGTHENED SOIL WALLS (PANELS) WILL BE SHOWN ON ALL ELEVATIONS AND DETAILS.

- UNLESS NOTED OTHERWISE, BACKFILL MATERIAL SHALL BE COMPACTED IN ACCORDANCE WITH THE SPECIFICATIONS FOR REINFORCED SOIL WALL(S) TO A LEVEL OF 51MM(+)
ABOVE THE HIGHEST REINFORCING STRIP. INSTALLATION OF REINFORCING STRAP SHALL BE PERMITTED ONLY AFTER PLACEMENT AND COMPACTION OF BACKFILL HAS ATTAINED THE REQUIRED LEVEL.

- REINFORCED SOIL WALLS, IN CURVES, IF REQUIRED WILL FORM A SERIES OF SHORT CHORDS ALONG PANEL FACE TO MATCH DESIRED WALL ALIGNMENT.

- PILES OR SHAFTS WITHIN THE REINFORCED SOIL VOLUME SHALL BE CONSTRUCTED PRIOR TO THE CONSTRUCTION OF THE STRENGTHENED SOIL WALL(S).

- HEAVY COMPACTION AND CONSTRUCTION EQUIPMENT SHALL BE KEPT A MINIMUM DISTANCE OF 1.0m FROM THE BACK FACE OF THE STRENGTHENED SOIL PANEL. COMPACTION WITHIN 1.0m OF THE STRENGTHENED SOIL PANEL(S) SHALL BE ACHIEVED WITH AT LEAST THREE PASSES ON A LIGHTWEIGHT MECHANICAL TAMPER, ROLLER OR VIBRATORY SYSTEM.

- ANY DAMAGE DONE TO THE REINFORCING STRIP DUE TO THE INSTALLATION OF ANY STRUCTURE WITHIN THE REINFORCED SOIL VOLUME SHALL BE REPAIRED.

- THE GAP BETWEEN THE PANELS SHALL BE 19mm(3/4") SUCH THAT THE FILTER FABRIC CANNOT BE SEEN.

- ALL PANELS SHALL HAVE A MINIMUM OF 4 LOOPS UNLESS NOTED OTHERWISE.

- THE MAXIMUM EDGE DISTANCE FOR SOIL REINFORCING SHALL BE 457mm UNLESS OTHERWISE DETAILED.

- NO SEISMIC FACTORS HAVE BEEN CALCULATED IN THE WALL DESIGNS.

SPECIFICATION OF STRIPS

POLYMER/TYPE	UNIT	SOIL (mm)		SOIL (mm)		SOIL (mm)		SOIL (mm)	
		POLYMER	POLYMER	POLYMER	POLYMER	POLYMER	POLYMER	POLYMER	POLYMER
MATERIAL	GRADE	POLYMER	POLYMER	POLYMER	POLYMER	POLYMER	POLYMER	POLYMER	POLYMER
WEIGHTS	mm	1.8x0.3	2.0x0.3	2.2x0.3	2.4x0.3	2.6x0.3	3.0x0.3	4.0x0.3	5.0x0.3
WEIGHT	g/AM	100±10%	150±10%	200±10%	250±10%	300±10%	350±10%	400±10%	450±10%
TENSILE STRENGTH	UN/FULL WIDTH	>20	<12	>30	<12	>50	>70	>100	>150
ELONGATION	%	<12	<12	<12	<12	<12	<12	<12	<12
WIDTH	mm	82±3	90±3	90±3	90±3	90±3	90±3	90±3	90±3
SOIL WEIGHT	kg	100-500	100-500	100-500	100-500	100-500	100-500	100-500	100-500

TITLE
GENERAL NOTES & SPECIFICATIONS

SECTION	MINIMUM DEPTH (ft)	MAXIMUM DEPTH (ft)	NUMBER OF LAYERS					NUMBER OF STOPS						
			1	2	3	4	5	1	2	3	4	5		
S-17	10.20	11.50	1	4	4	3	2	2	2	2	2	2	2	2
S-18	8.71	11.15	1	7	4	4	3	2	2	2	2	2	2	2
S-19	10.78	10.50	1	3	4	3	3	2	2	2	2	2	2	2
S-20	10.88	8.85	1	1	4	3	2	2	2	2	2	2	2	2
S-21	10.54	8.50	1	1	4	3	2	2	2	2	2	2	2	2
S-22	10.51	8.50	1	1	4	3	2	2	2	2	2	2	2	2
S-23	11.08	7.50	1	1	4	3	2	2	2	2	2	2	2	2
S-24	11.08	7.50	1	1	4	3	2	2	2	2	2	2	2	2
S-25	10.54	8.50	1	1	4	3	2	2	2	2	2	2	2	2
S-26	10.54	8.50	1	1	4	3	2	2	2	2	2	2	2	2
S-27	10.54	8.50	1	1	4	3	2	2	2	2	2	2	2	2
S-28	10.54	8.50	1	1	4	3	2	2	2	2	2	2	2	2
S-29	10.54	8.50	1	1	4	3	2	2	2	2	2	2	2	2
S-30	10.54	8.50	1	1	4	3	2	2	2	2	2	2	2	2
S-31	10.54	8.50	1	1	4	3	2	2	2	2	2	2	2	2
S-32	10.54	8.50	1	1	4	3	2	2	2	2	2	2	2	2
S-33	10.54	8.50	1	1	4	3	2	2	2	2	2	2	2	2
S-34	10.54	8.50	1	1	4	3	2	2	2	2	2	2	2	2
S-35	10.54	8.50	1	1	4	3	2	2	2	2	2	2	2	2
S-36	10.54	8.50	1	1	4	3	2	2	2	2	2	2	2	2
S-37	10.54	8.50	1	1	4	3	2	2	2	2	2	2	2	2
S-38	10.54	8.50	1	1	4	3	2	2	2	2	2	2	2	2
S-39	10.54	8.50	1	1	4	3	2	2	2	2	2	2	2	2
S-40	10.54	8.50	1	1	4	3	2	2	2	2	2	2	2	2
S-41	10.54	8.50	1	1	4	3	2	2	2	2	2	2	2	2
S-42	10.54	8.50	1	1	4	3	2	2	2	2	2	2	2	2
S-43	10.54	8.50	1	1	4	3	2	2	2	2	2	2	2	2
S-44	10.54	8.50	1	1	4	3	2	2	2	2	2	2	2	2
S-45	10.54	8.50	1	1	4	3	2	2	2	2	2	2	2	2
S-46	10.54	8.50	1	1	4	3	2	2	2	2	2	2	2	2
S-47	10.54	8.50	1	1	4	3	2	2	2	2	2	2	2	2
S-48	10.54	8.50	1	1	4	3	2	2	2	2	2	2	2	2
S-49	10.54	8.50	1	1	4	3	2	2	2	2	2	2	2	2
S-50	10.54	8.50	1	1	4	3	2	2	2	2	2	2	2	2
S-51	10.54	8.50	1	1	4	3	2	2	2	2	2	2	2	2
S-52	10.54	8.50	1	1	4	3	2	2	2	2	2	2	2	2
S-53	10.54	8.50	1	1	4	3	2	2	2	2	2	2	2	2
S-54	10.54	8.50	1	1	4	3	2	2	2	2	2	2	2	2
S-55	10.54	8.50	1	1	4	3	2	2	2	2	2	2	2	2
S-56	10.54	8.50	1	1	4	3	2	2	2	2	2	2	2	2
S-57	10.54	8.50	1	1	4	3	2	2	2	2	2	2	2	2
S-58	10.54	8.50	1	1	4	3	2	2	2	2	2	2	2	2
S-59	10.54	8.50	1	1	4	3	2	2	2	2	2	2	2	2
S-60	10.54	8.50	1	1	4	3	2	2	2	2	2	2	2	2

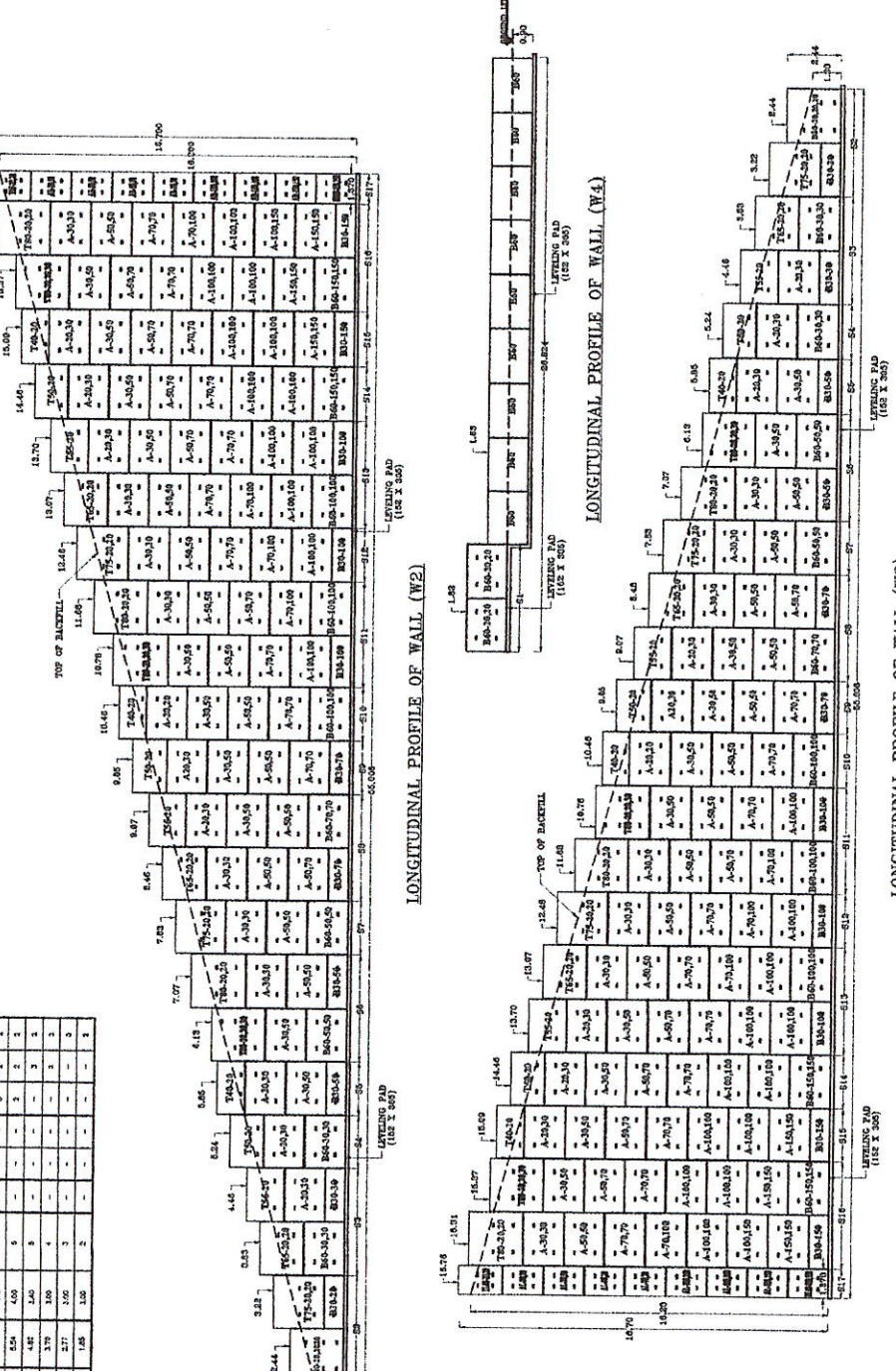
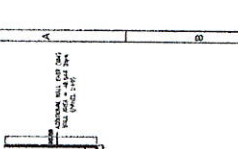
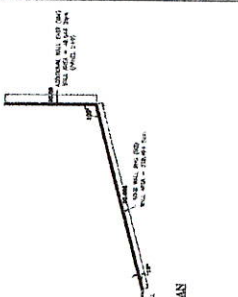
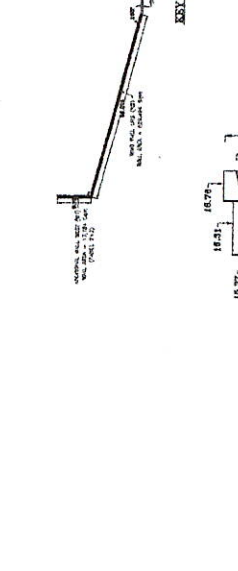
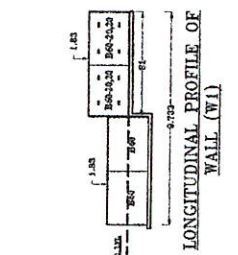

TITLE
VERTICAL CROSS SECTION OF
REINFORCED SOIL WALL

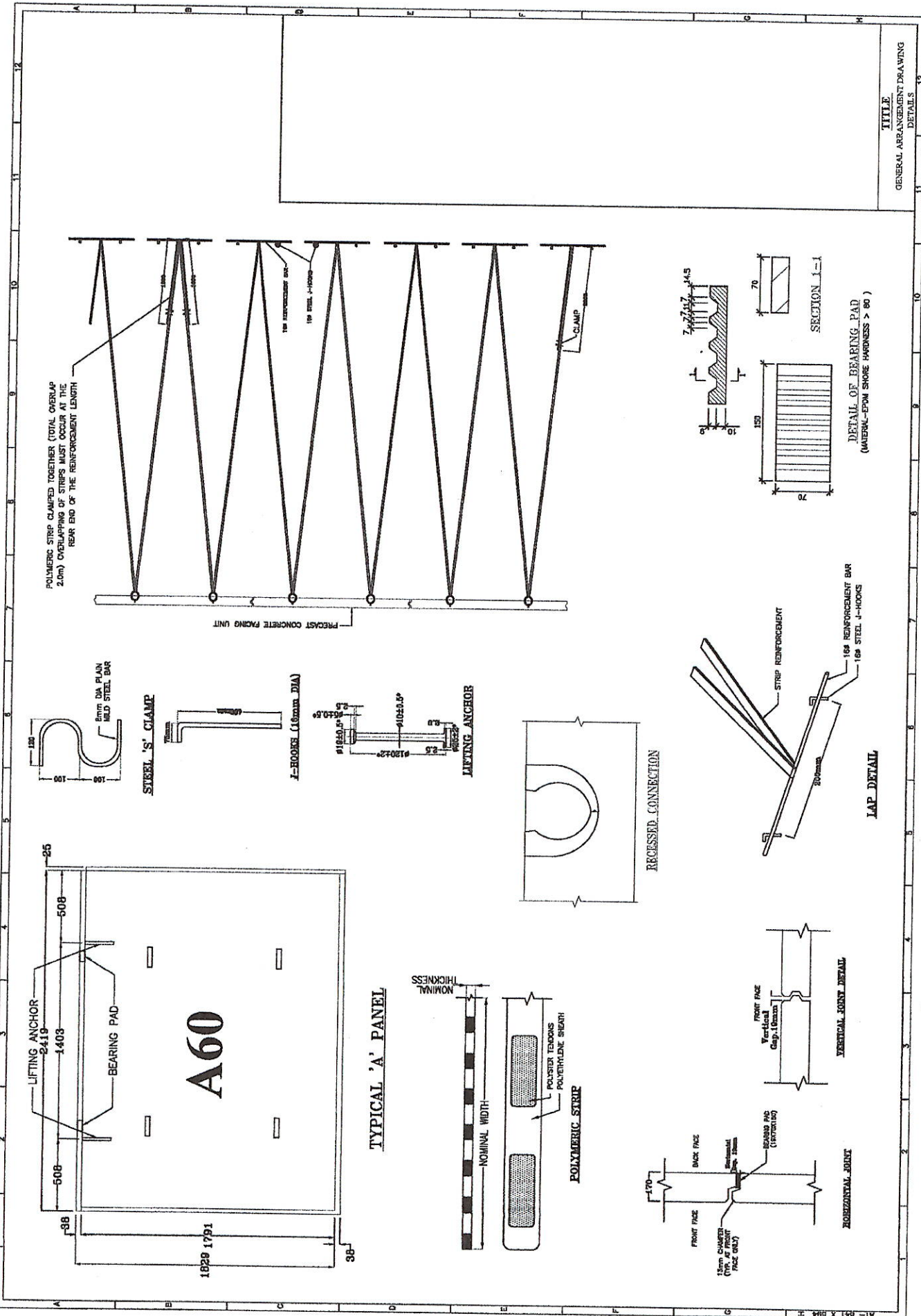

TITLE
GENERAL ARRANGEMENT DRAWING
DETAILS

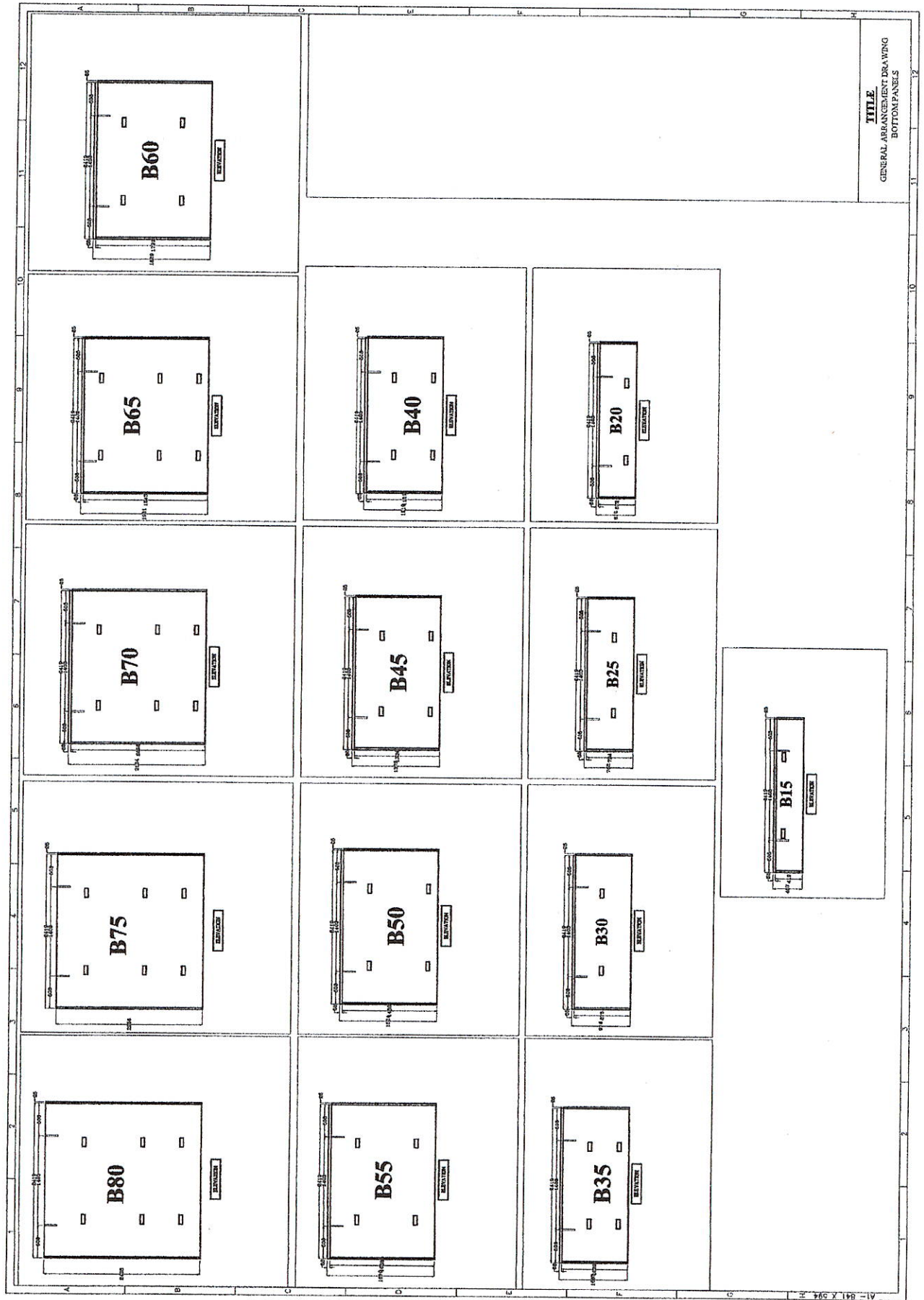

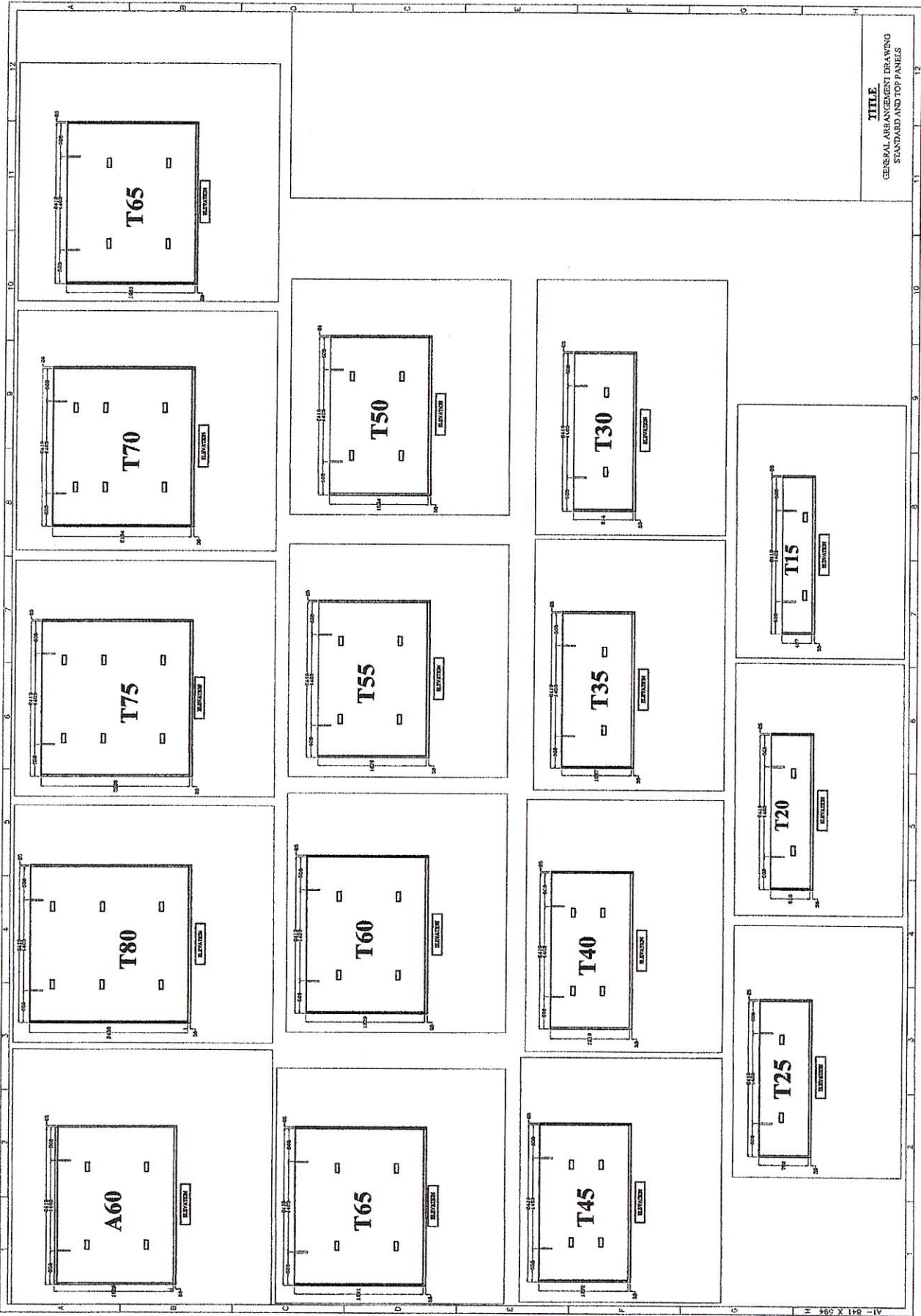

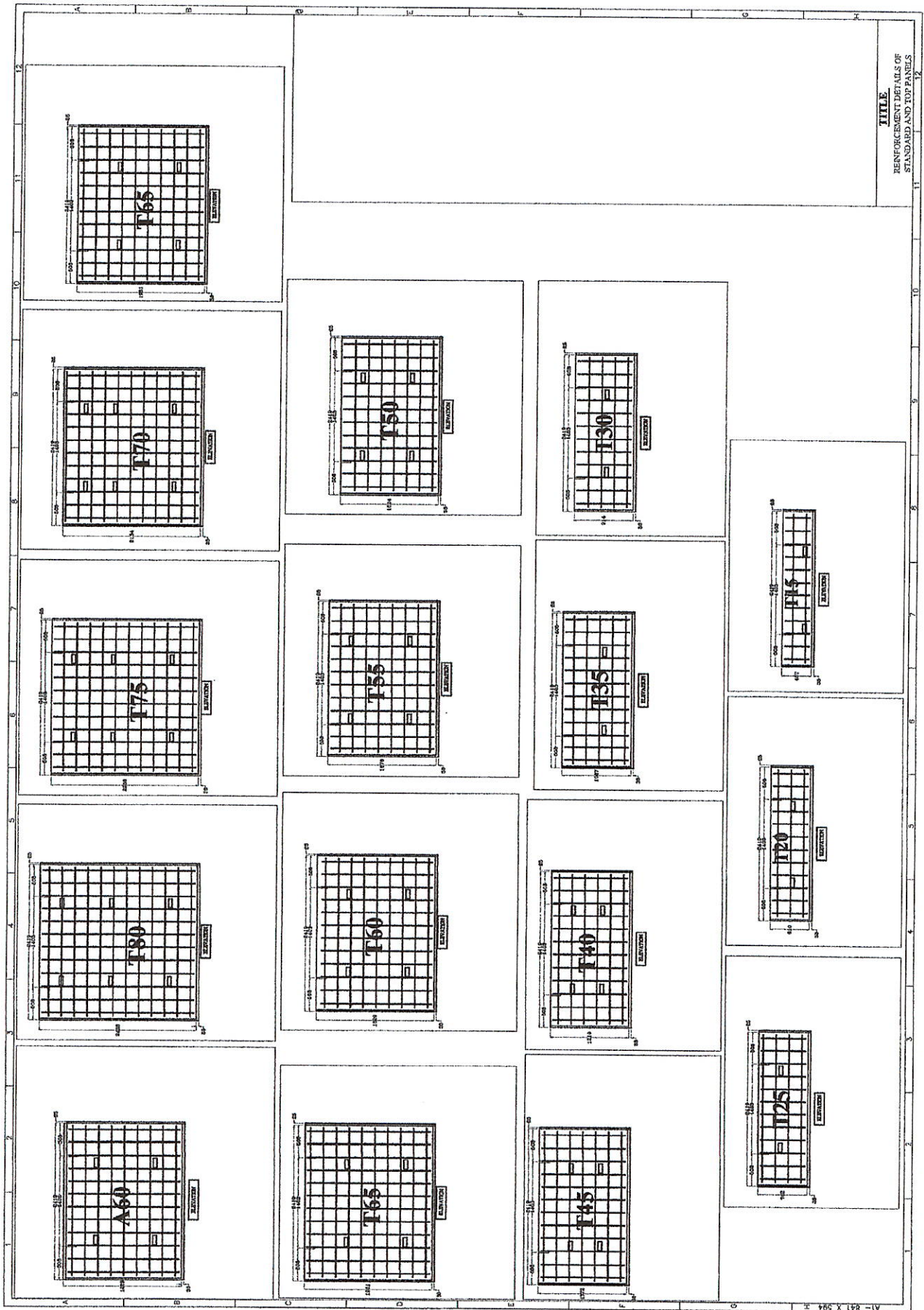

TITLE
 REINFORCEMENT DETAILS OF
 STANDARD AND TOP PANELS

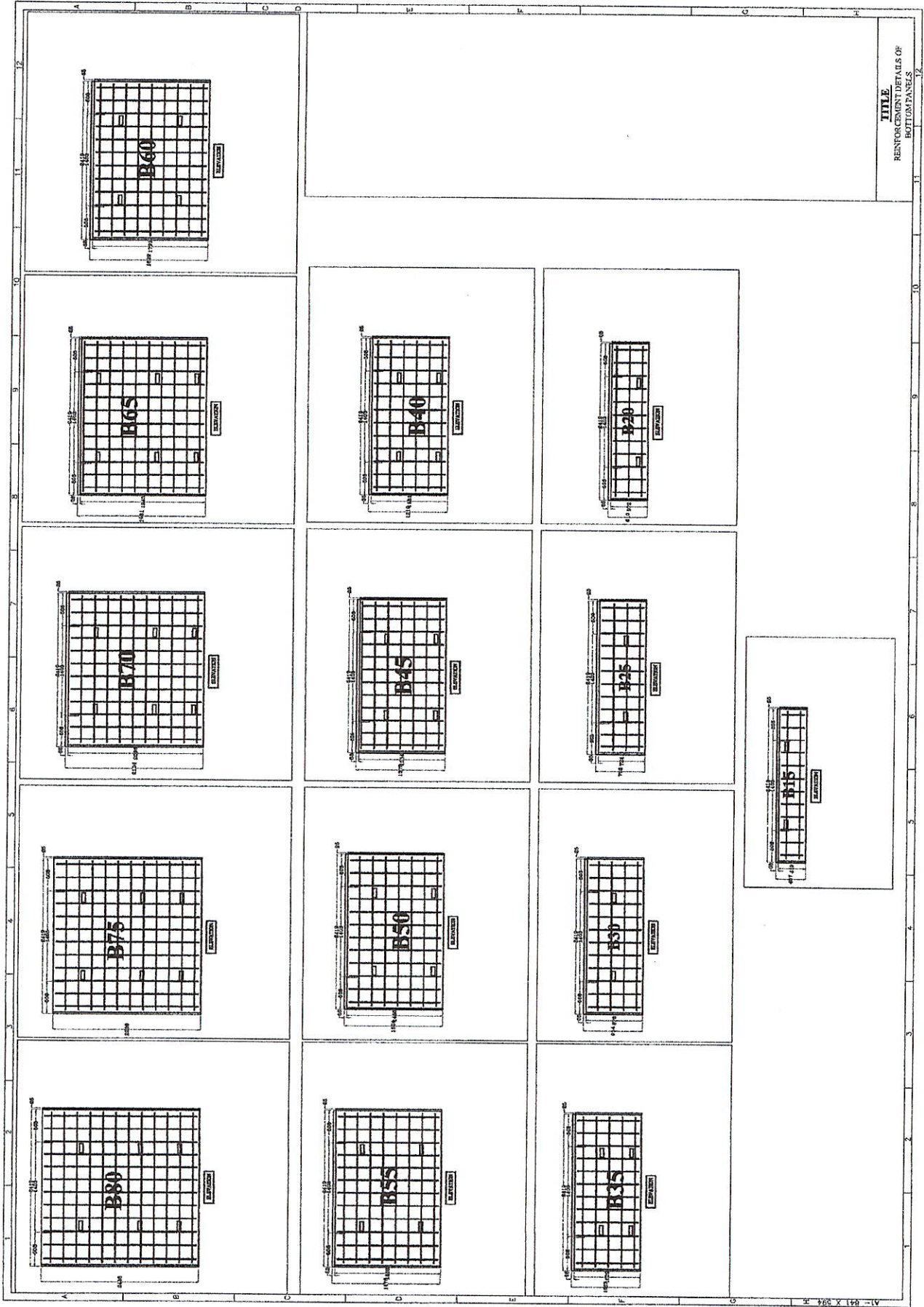

TITLE
 REINFORCEMENT DETAILS OF
 BOTTOM BARS

